

•After an application of charge-discharge voltage for 10million times

Charge
dischargeenergy
storageripple
current

RoHS

•Applicable to atm give card back, Start the polysilicon reducing power, solar photovoltaic, Glass fiber, iron and steel metallurgy, petrochemical, machinery manufacturing, Nuclear power Etc Equipment, cnc lathe, cnc mill, spark tester, Surface grinder, the drilling dynamometer, Machining center machine, Carving machine Etc Equipment

◆ SPECIFICATIONS

items	characteristics			
Category temperature Range	-25~+85℃			
Rated voltage Range	350~550 _{VDC}			
Capacitance Tolerance	± 20% (M)			at 20℃/120HZ
Leakage Current	I=0.02CV or 5mA, whichever is smaller I: Where, I : Max. leakage current (μA), C: Nominal capacitance (μF), Rated voltage (V) at 20℃ after 5 minutes)			
Dissipation Factor (tanδ)	0.25max			at 20℃/120HZ
Low Temperature characteristics	Rated voltage(vdc)	350to450V	500to550v	at 20℃/120HZ
	C (-25℃)/C (+20℃)	≥0.7	≥0.6	
Insulation Resistance	When measured between the terminals that are connected to each other and to the mounting clamp on the insulating sleeve covering the case by using an insulation resistance meter of 500Vdc, the insulation resistance shall not be less than 100mΩ			
Insulation Withstanding Voltage	When a voltage of 2,000Vac is applied for 1 minute between the terminals that are connected to each other and to the mounting clamp on the insulating sleeve covering the case, there shall not be electrical damage.			
Endurance of charge-discharge behavior	After an application of charge-discharge voltage for 10million times (charge-discharge voltage difference (ΔV)=rated voltage x 0.3, cycle 3HZ) capacitors shell meet the characteristics requirement listed at right at (15℃~35℃)			
	Capacitance change	≤±20% of the initial value		
	D.F. (tanδ)	≤300% of the initial specified value		
	Leakage current	≤The initial specified value		
	Appearance	There shall be found to remarkable abnormality on the capacitor		
Shelf Life	The following specifications shall be satisfied when the capacitors are restored to 20℃ after exposing them for 1000 hours at 85℃ without voltage applied. Before the measurement, the capacitor shall be preconditioned by applying voltage according to Item 4.1 of JIS C 5101 -4			
	Capacitance change	≤±20% of the initial value		
	D.F. (tanδ)	≤300% of the initial specified value		
	Leakage current	≤The initial specified value		

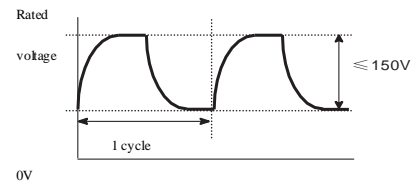

◆ DIMENSIONS[mm]

● Terminal Code : M5

● Mounting Clamp Code : B

● Mounting Clamp Code : C

● NO Mounting Clamp Code : N

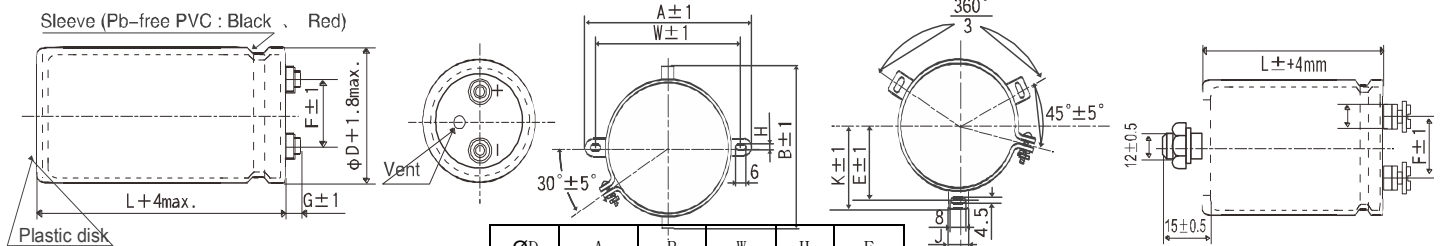

Ø35~ Ø63.5: G=6

Ø76.2~ Ø89: G=5

Screw specifications

~ ~ Plus hexagon-headed screw M5*0.8*10 M6*1.0*10 Ø100

Maximum screw tightening torque 3.23N.m The screw and the mounting clamp are separately supplied and not attached to the product

ØD	A	B	W	H	F
35	58.0	44.0	48.0	3.5	12.7
50	78.0	64.0	68.0	4.5	22.4
63.5	90.0	76.0	80.0	4.5	28.0
76.2	104.5	90.0	93.5	4.5	31.5

ØD	E	K	F	J
50	32.5	37.0	14.0	22.4
63.5	38.1	43.5	28.0	14.0
76.2	44.5	50.0	31.5	14.0
89	50.8	56.5	31.5	16.0
100	56.5	63.4	41.5	18.0



◆PART NUMBERING SYSTEM

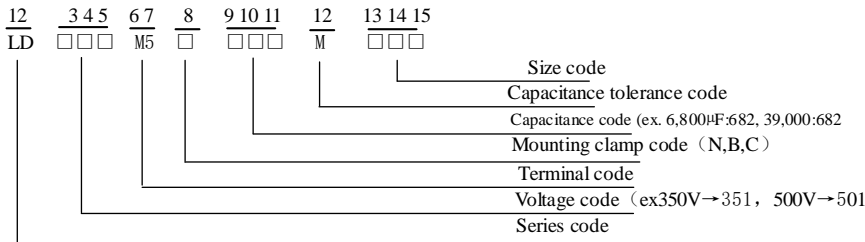

Please refer to "Product code guide (screw-mount terminal type)"

SRANDRAD RATINGS

W. V [Vdc]	cap [μ F]	Case size D x L [mm]	tanδ 120HZ, 20°C	Rated ripple current (Ams/ 85°C, 120HZ)	Part NO.	W. V [Vdc]	cap [μ F]	Case size D x L [mm]	tanδ 120HZ, 20°C	Rated ripple current (Ams/ 85°C, 120HZ)	Part NO.	
350	1500	50*65	0.25	5.09	LD351M5C152MC65	450	3900	63.5*130	0.25	11.4	LD451M5C392MDD0	
	1800	50*75	0.25	5.93	LD351M5C182MC75		3900	76.2*96	0.25	11.1	LD451M5C392ME96	
	2200	50*96	0.25	7.3	LD351M5C222MC96		4700	63.5*155	0.25	13.6	LD451M5C472MDF5	
	2700	50*115	0.25	8.76	LD351M5C272MCB5		4700	76.2*115	0.25	13.2	LD451M5C472MEB5	
	3300	63.5*85	0.25	9.71	LD351M5C332MD85		5600	76.2*130	0.25	15.2	LD451M5C562MED0	
	3900	50*130	0.25	11.1	LD351M5C392MCD0		6800	76.2*155	0.25	18.1	LD451M5C682MEF5	
	3900	63.5*96	0.25	11.1	LD351M5C392MD96		8200	89*130	0.25	19.2	LD451M5C822MFD0	
	4700	63.5*115	0.25	13.2	LD351M5C472MDB5		500	470	50*60	0.25	2.17	LD501M5C471MC60
	5600	63.5*130	0.25	15.2	LD351M5C562MDD0			680	50*65	0.25	2.7	LD501M5C681MC65
	5600	76.2*96	0.25	14.3	LD351M5C562ME96			820	50*75	0.25	3.15	LD501M5C821MC75
	6800	76.2*115	0.25	17.0	LD351M5C682MEB5			1000	50*85	0.25	3.67	LD501M5C102MC85
	8200	76.2*130	0.25	19.6	LD351M5C822MED0			1200	50*96	0.25	4.22	LD501M5C122MC96
	10000	76.2*155	0.25	23.4	LD351M5C103MEF5			1500	50*115	0.25	5.14	LD501M5C152MCB5
	12000	89*130	0.25	24.1	LD351M5C123MFD0			1500	63.5*96	0.25	5.42	LD501M5C152MD96
15000	89*155	0.25	29.1	LD351M5C153MFF5	1800	50*130		0.25	5.95	LD501M5C182MCD0		
400	1200	50*65	0.25	4.55	LD401M5C122MC65	1800		63.5*96	0.25	5.94	LD501M5C182MD96	
	1500	50*75	0.25	5.41	LD401M5C152MC75	2200		63.5*115	0.25	7.1	LD501M5C222MDB5	
	1800	50*85	0.25	6.26	LD401M5C182MC85	2200		76.2*96	0.25	7.3	LD501M5C222ME96	
	2200	50*96	0.25	7.3	LD401M5C222MC96	2700		63.5*130	0.25	8.31	LD501M5C272MDD0	
	2700	50*115	0.25	8.76	LD401M5C272MCB5	3300		76.2*115	0.25	9.65	LD501M5C332MEB5	
	3300	63.5*96	0.25	10.2	LD401M5C332MD96	3900		76.2*130	0.25	11.1	LD501M5C392MED0	
	3900	63.5*115	0.25	12.0	LD401M5C392MDB5	4700	76.2*155	0.25	13.1	LD501M5C472MEF5		
	4700	63.5*130	0.25	13.9	LD401M5C472MDD0	6800	89*155	0.25	15.9	LD501M5C682MFF5		
	4700	76.2*96	0.25	13.1	LD401M5C472ME96	550	390	50*60	0.25	1.98	LD551M5C391MC60	
	5600	63.5*155	0.25	16.5	LD401M5C562MDF5		560	50*65	0.25	2.45	LD551M5C561MC65	
	6800	76.2*115	0.25	17.0	LD401M5C682MEB5		680	50*75	0.25	2.87	LD551M5C681MC75	
	8200	76.2*155	0.25	21.2	LD401M5C822MEF5		820	50*85	0.25	3.32	LD551M5C821MC85	
	10000	89*130	0.25	22.0	LD401M5C103MFD0		1200	50*115	0.25	4.6	LD551M5C122MCB5	
	12000	89*155	0.25	26.0	LD401M5C123MFF5		1500	63.5*96	0.25	5.42	LD551M5C152MD96	
450	1000	50*70	0.25	3.87	LD451M5C102MC70		1800	76.2*80	0.25	6.12	LD551M5C182ME80	
	1200	50*75	0.25	4.36	LD451M5C122MC75		2200	76.2*96	0.25	7.3	LD551M5C222ME96	
	1500	50*90	0.25	5.28	LD451M5C152MC90		2700	76.2*115	0.25	8.73	LD551M5C272MEB5	
	1800	50*96	0.25	5.95	LD451M5C182MC96		3300	76.2*130	0.25	10.2	LD551M5C332MED0	
	2200	50*130	0.25	7.54	LD451M5C222MCD0		5600	89*155	0.25	14.5	LD551M5C562MFF5	
	2700	63.5*96	0.25	8.34	LD451M5C272MD96							
	3300	63.5*115	0.25	9.97	LD451M5C332MDB5							

◆ RTED RIPPLE CURRENT MUIERS

The ripple frequency and standard list of the specified value is not at the same time, please use the value is less than the following

● Frequency Multipliers

Frequency (HZ)	50	120	300	1K	3K
coefficient	0.8	1.0	1.1	1.3	1.4

Note : The endurance of capacitors is shorted with internal heating produced by ripple current at the rate of halving the lifetime with every 5 to 10°C rise. When long life performance is required in actual use, the rms ripple current has to be reduced. Also, for the LB series capacitors, using them at operating voltage less than their rated voltage can extend their lifetime. For the details, please contact representative of capsun